



**KOMAX**

# STAINLESS STEEL WATER METER

## Special Feature:

- Non-toxic, non-abrasive, semi-permanent, recycled product.
- Unleaded, rust-proof
- Good durability, stability against flow rate and temperature variations
- Built-in check value for prevention of back flow
- Tempered glass protects from freezing and bursting

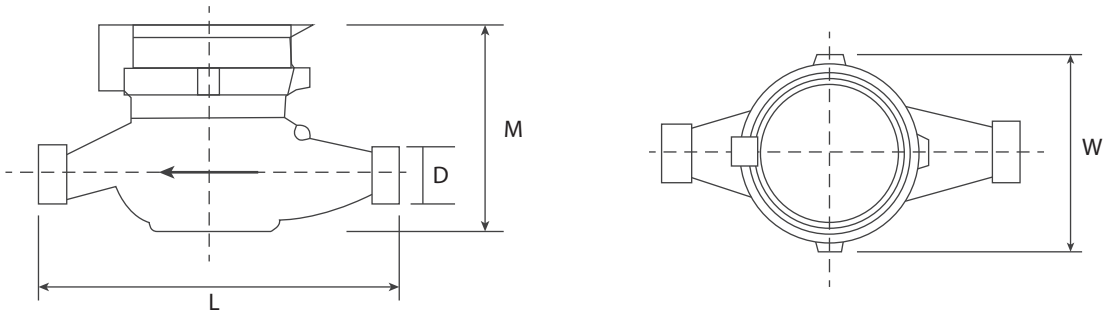

## DIMENSIONS

Type	Size	L Length	B Width	H Height	d Connecting Thread
KM-15	15	165	98	116	G <sup>3</sup> / <sub>4</sub> B
KM-20	20	190	98	117	G1B
KM-25	25	260	103.5	124	G1 <sup>1</sup> / <sub>4</sub> B
KM-32	32	260	103.5	124	G1 <sup>1</sup> / <sub>2</sub> B
KM-40	40	300	125	162	G2B
KM-50	50	300	125	162	G2 <sup>1</sup> / <sub>2</sub> B

## MAIN TECHNICAL SPECIFICATIONS

Type	Size (mm)	Class	q <sub>s</sub> Overload Flow	q <sub>p</sub> Permanent Flow	q <sub>t</sub> Transitional Flow	q <sub>min</sub> Minimum Flow	Minimum Reading	Maximum Reading
			m <sup>3</sup> /h		L/h			
KM-15	15	B	3	1.5	120	30	0.00005	99.999
KM-20	20	B	5	2.5	200	50	0.00005	99.999
KM-25	25	B	7	3.5	280.0	70	0.00005	99.999
KM-32	32	B	12	6.0	480	120	0.00005	99.999
KM-40	40	B	20	10	800	200	0.00005	99.999
KM-50	50	B	30	15	3000	450	0.00005	99.999

# ISO 4064



## MAIN TECHNICAL SPECIFICATIONS

Type	Size (mm)	Class	$q_s$	$q_p$	$q_t$	$q_{min}$	Minimum Reading	Maximum Reading
			Overload Flow	Permanent Flow	Transitional Flow	Minimum Flow		
m <sup>3</sup> /h							m <sup>3</sup>	
DN50	50	B	31.25	25	0.8	0.5	0.001	999.999
DN65	65	B	50	40	1.28	0.8	0.001	999.999
DN80	80	B	78.75	63	2.016	1.26	0.001	999.999
DN100	100	B	125	100	3.2	2.0	0.001	999.999
DN125	125	B	200	160	5.12	3.2	0.01	999.999
DN150	150	B	312.5	250	8	5	0.01	999.999
DN200	200	B	500	400	12.8	8	0.01	999.999
DN250	250	B	787.5	630	20.16	12.6	0.01	999.999
DN300	300	B	1250	1000	32	20	0.01	9.999.999
DN400	400	B	2000	1000	200	30	0.02	9.999.999
DN500	500	B	3000	1500	300	45	0.02	9.999.999



## DIMENSION

Size DN	L Length	H Height	Connecting Flange		
			$\varphi_{D1}$ Outside diameter	$\varphi_{D2}$ Bolt circle diameter	Connecting Bolts (n-M)
mm					
50	200	261	165	125	4-M16
65	200	271	185	145	4-M16
80	225	279	200	160	8-M16
100	250	289	220	180	8-M16
125	250	299	250	210	8-M16
150	300	319	285	240	8-M20
200	350	346	340	295	8-M20(1.0MPa)
					12-M20(1.6MPa)
250	400	434	395	350	12-M20(1.0MPa)
	450	434	405	355	12-M24(1.6MPa)
300	450	459	445	400	12-M20(1.0MPa)
	500	459	460	410	12-M24(1.6MPa)
400	600	630	565	515	16-M24
500	800	738	620	570	20-M24

**PRESSURE : PN16**  
**MATERIAL: SUS 304**